

CE RoHS EASCO® Nylon Cable Chains Mini 7 Series-can not be opened EASCO® 尼龙拖链微型7系列-不可打开

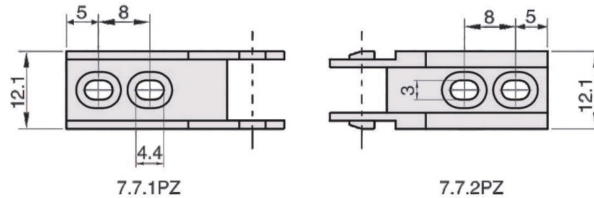

Basic technical data:

- Pitch=17mm, Number of sections per meter=59.
 - Chain length=S/2+K, S=traveldistance, K=π.R+"safe amount".
- 主要技术参数:
- 节距=17mm, 每米节数=59。
 - 链长=S/2+K, S=行程距离, K=π.R+"安全量"。

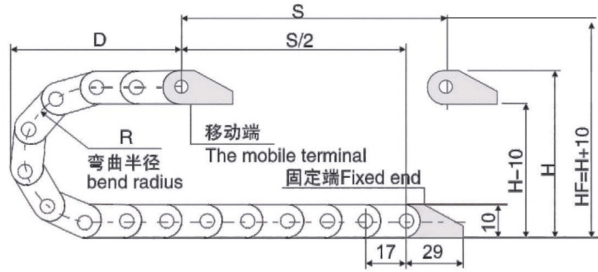
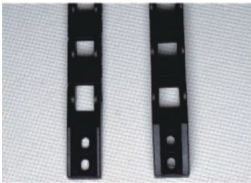
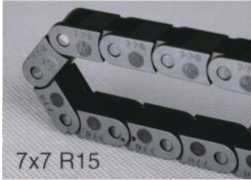

Connector Installation Dimensions 接头安装尺寸图

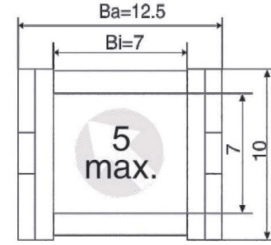

Delineation 示意图

R	15	28
H	40	66
D	37	62
K	52	105

Article No.	Part No.	Hi	Bi	H	Ba	Bending Radius	Open The Way	Corresponds To The Hole Pitch	Connector Ordering Model
货号	型号	内高	内宽	外高	外宽	弯曲半径 (R)	打开方式	对应接头孔距 (mm)	接头订购型号
A0119.000.0001	7	7	7	10	12.5	15,28	B	A=8	7.7.B.1PZ/2PZ

*Note:Open mode B is not open type.

*Connector type:7...B.12P2 = Complete U-shaped bevel connector; 7...B.1PZ = One end with hole; 7...B.2PZ = One end with pin.

*注:打开方式B为不可打开型。

*接头型号:7...B.12P2=U型斜角接头全套;7...B.1PZ=一端带孔;7...B.2PZ=一端带销。

CE RoHS

EASCO® Nylon Cable Chains Mini 10 Series-Convenient/Bridge EASCO® 尼龙拖链微型10系列-便捷式/桥式

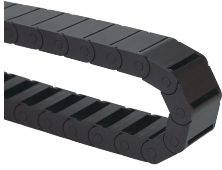

- Basic technical data:
- Pitch=15mm, Number of sections per meter=66.
 - Chain length=S/2+K, S=travel distance, K=π.R+"safe amount".
- 主要技术参数:
- 节距=15mm, 每米节数=66。
 - 链长=S/2+K, S=行程距离, K=π.R+"安全量"。

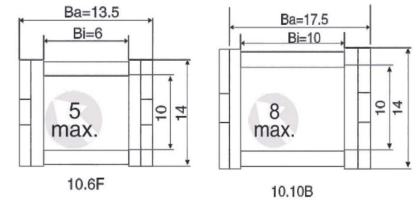
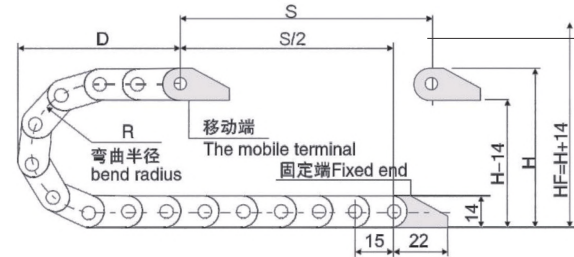
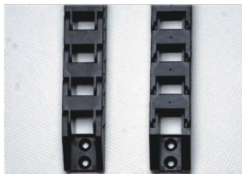
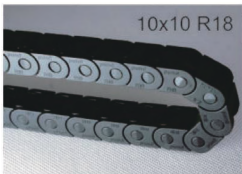
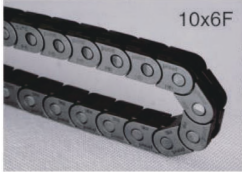

Delineation 示意图

R	18	28
H	50	70
D	45	55
K	72	103

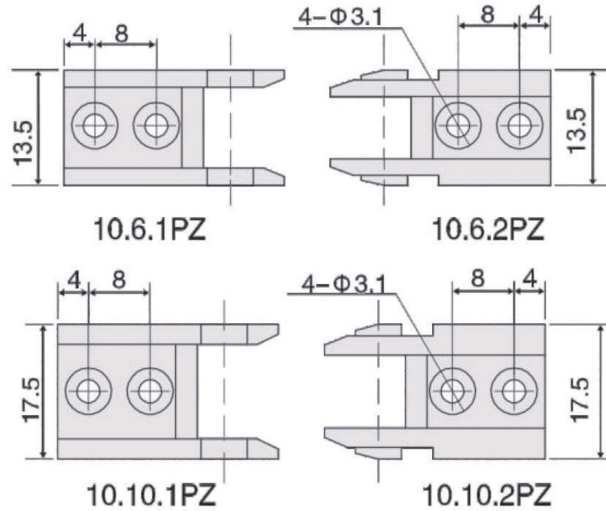

Connector Installation Dimensions 接头安装尺寸图

Article No.	Part No.	Hi	Bi	H	Ba	Bending Radius	Open The Way	Corresponds To The Hole Pitch	Connector Ordering Model
货号	型号	内高	内宽	外高	外宽	弯曲半径 (R)	打开方式	对应接头孔距 (mm)	接头订购型号
A0119.001.0001	10 Series Convenient (10 型便捷式)	10	6	14	13.5	18	F	A=8	10.6.F.1PZ/2PZ
A0119.001.0002	10 Series Bridge (10 型桥式)	10	10	14	17.5	18,28	B	A=8	10.10.B.1PZ/2PZ

- *Note: Open mode B is not open type, and F is external convenient.
- *Connector type: 10...B.12PZ = Complete U-shaped bevel connector, 10...B.1PZ = One end with hole; 10...B.2PZ = One end with pin.
- *注: 打开方式B为不可打开型, F为外侧便捷式。
- *接头型号: 10...B.12PZ=U型斜角接头全套; 10...B.1PZ=一端带孔; 10...B.2PZ=一端带销。

A1. Wiring Ducts

A2. Cable Ties

A3. Din Rails

A4. Cable Markers

A5. Cable Clamps

A6. Wrapping Bands

A7. Nylon Cable Gland

A8. Metal Cable Gland

A9. Plastic Flexible Conduit

A10. Metal Flexible Conduit

A11. Terminal

A12. Copper Tube Terminals

A13. Heat Shrinkable Tubings

A14. Bus Bar Insulators

A15. Tool

A16. Cable Clip

A17. Insulating Nut

A18. Nylon Cable Carrier

CE RoHS

EASCO® Nylon Cable Chains Mini 10 Series-can not be opened EASCO® 尼龙拖链微型10系列-不可打开

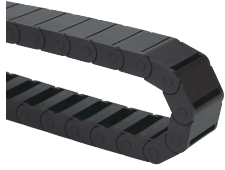

Basic technical data:

- Pitch=20mm, Number of sections per meter=50.
 - Chain length=S/2+K, S=travel distance, K=π.R+"safe amount".
- 主要技术参数:
- 节距=20mm, 每米节数=50。
 - 链长=S/2+K, S=行程距离, K=π.R+“安全量”。

- A1. Wiring Ducts
- A2. Cable Ties
- A3. Din Rails
- A4. Cable Markers
- A5. Cable Clamps
- A6. Wrapping Bands
- A7. Nylon Cable Gland
- A8. Metal Cable Gland
- A9. Plastic Flexible Conduit
- A10. Metal Flexible Conduit
- A11. Terminal
- A12. Copper Tube Terminals
- A13. Heat Shrinkable Tubings
- A14. Bus Bar Insulators
- A15. Tool
- A16. Cable Clip
- A17. Insulating Nut
- A18. Nylon Cable Carrier



10x15



10x20



10x30

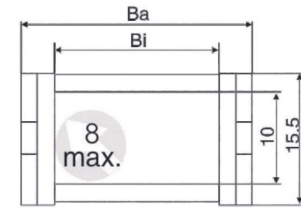
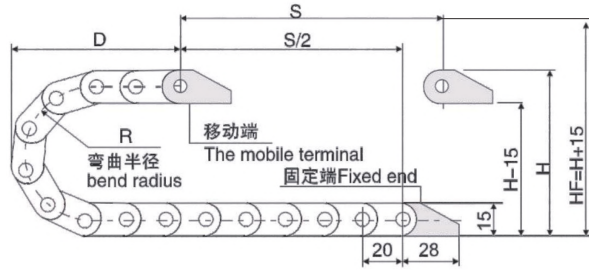

Delineation 示意图

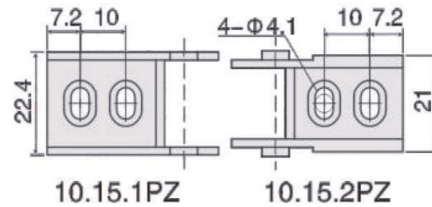

10.15.1PZ

10.15.2PZ

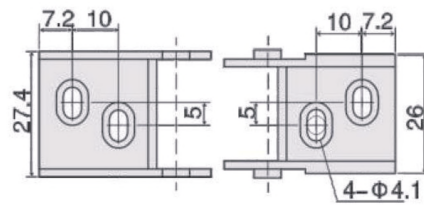

10.20.1PZ

10.20.2PZ

R	18	28	38*
H	52	72	92
D	45	55	65
K	100	140	160

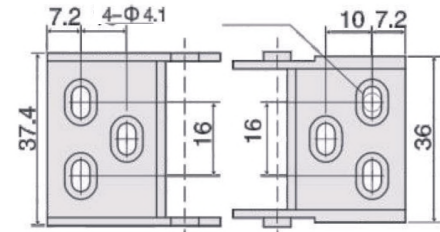

10.30.1PZ

10.30.2PZ

Connector Installation Dimensions 接头安装尺寸图

Article No.	Part No.	Hi	Bi	H	Ba	Bending Radius	Open The Way	Corresponds To The Hole Pitch	Connector Ordering Model
货号	型号	内高	内宽	外高	外宽	弯曲半径 (R)	打开方式	对应接头孔距 (mm)	接头订购型号
A0119.002.0001	10	10	15	15.5	23	18,28,38*	Q,BF	A=10	10.15.B.1PZ/2PZ
A0119.002.0002	10	10	20	15.5	28	18,28,38*	Q,BF	A=10,B=5	10.20.B.1PZ/2PZ
A0119.002.0003	10	10	30	15.5	38	18,28,38*	Q,BF	A=10,B=16	10.30.B.1PZ/2PZ

*Note: The opening method Q is a bridge type non opening type, and BF is a semi closed non opening type.

*Connector type: 10...B.12PZ = Complete U-shaped bevel connector, 10...B.1PZ = One end with hole; 10...B.2PZ = One end with pin.

*注: 打开方式Q为桥式不可打开型, BF为半封闭不可打开型。

*接头型号: 10...B.12PZ=U型斜角接头全套; 10...B.1PZ=一端带孔; 10...B.2PZ=一端带销。

CE RoHS

EASCO® Nylon Cable Chains Series 15-Semi-enclosed open inside EASCO® 尼龙拖链15系列-半封闭内侧打开



Basic technical data:

- Pitch=20mm, Number of sections per meter=50.
 - Chain length=S/2+K, S=travel distance, K=π.R+"safe amount".
- 主要技术参数:
- 节距=20mm, 每米节数=50。
 - 链长=S/2+K, S=行程距离, K=π.R+“安全量”。



15x15

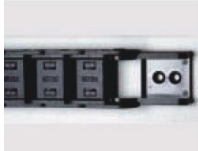

15x20



15x30



15x40



15x50

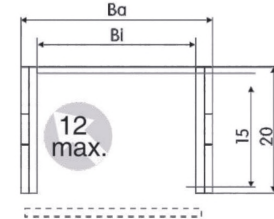
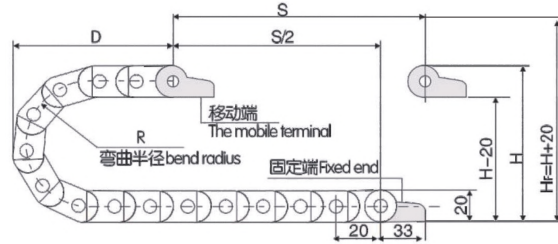

Delineation 示意图

R	28	38	48
H	76	96	116
D	60	70	80
K	130	160	190

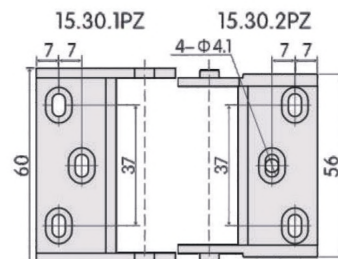
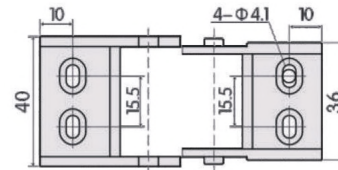
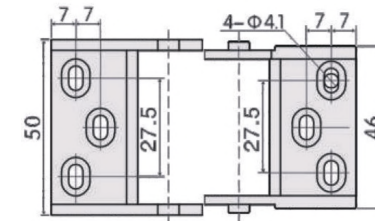
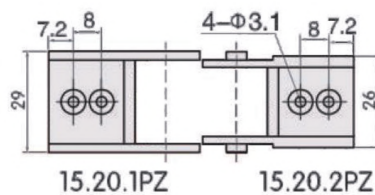
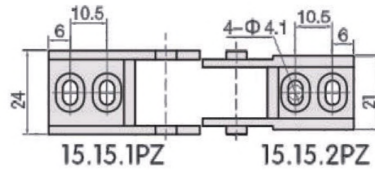

15.40.1PZ 15.40.2PZ 15.50.1PZ 15.50.2PZ

Connector Installation Dimensions 接头安装尺寸图

Article No.	Part No.	Hi	Bi	H	Ba	Bending Radius	Open The Way	Corresponds To The Hole Pitch	Connector Ordering Model
货号	型号	内高	内宽	外高	外宽	弯曲半径 (R)	打开方式	对应接头孔距 (mm)	接头订购型号
A0119.003.0001	15	15	15	20	23	28,38,48	BF.N	A=10.5	15.15.1PZ/2PZ
A0119.003.0002	15	15	20	20	28	28,38,48	BF.N	B=8	15.20.1PZ/2PZ
A0119.003.0003	15	15	30	20	38	28,38,48	BF.N	B=15.5	15.30.1PZ/2PZ
A0119.003.0004	15	15	40	20	48	28,38,48	BF.N	A=7, B=27.5	15.40.1PZ/2PZ
A0119.003.0005	15	15	50	20	58	28,38,48	BF.N	A=7, B=37	15.50.1PZ/2PZ

*Note: The opening method BF is semi-closed type, N is the inside open type, Bf.N is the semi-closed inside open type.

*Connector type: 15...B.12PZ = Complete U-shaped bevel connector, 15...B.1PZ = One end with hole; 15...B.2PZ = One end with pin.

*注: 打开方式BF为半封闭型, N为内侧打开型, BF.N为半封闭内侧打开型。

*接头型号: 15...B.12PZ=U型斜角接头全套; 15...B.1PZ=一端带孔; 15...B.2PZ=一端带销。

A1. Wiring Ducts

A2. Cable Ties

A3. Din Rails

A4. Cable Markers

A5. Cable Clamps

A6. Wrapping Bands

A7. Nylon Cable Gland

A8. Metal Cable Gland

A9. Plastic Flexible Conduit

A10. Metal Flexible Conduit

A11. Terminal

A12. Copper Tube Terminals

A13. Heat Shrinkable Tubings

A14. Bus Bar Insulators

A15. Tool

A16. Cable Clip

A17. Insulating Nut

A18. Nylon Cable Chains

CE RoHS

EASCO® Nylon Cable Chains 18 Series-Semi-closed inside open EASCO® 尼龙拖链18系列-半封闭内侧打开

Basic technical data:

- Pitch=34mm, Number of sections per meter=30.
 - Chain length=S/2+K, S=travel distance, K=π.R+"safe amount".
- 主要技术参数:
- 节距=34mm, 每米节数=30.
 - 链长=S/2+K, S=行程距离, K=π.R+"安全量".



18x18



18x25



18x37



18x50

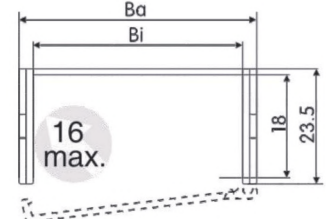
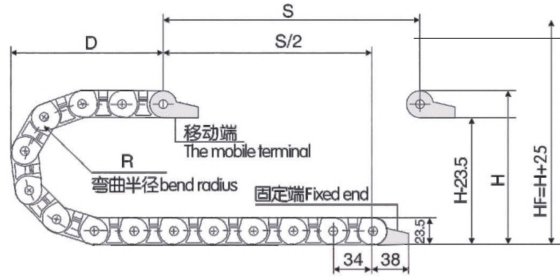
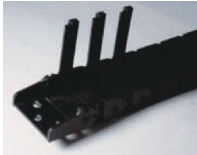

Delineation 示意图

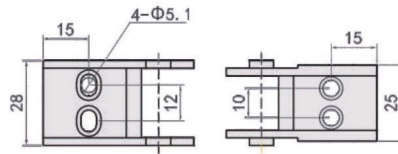

R	28	38	48	60	75	100
H	80	100	120	145	175	225
D	70	80	90	100	120	145
K	150	185	215	250	300	375

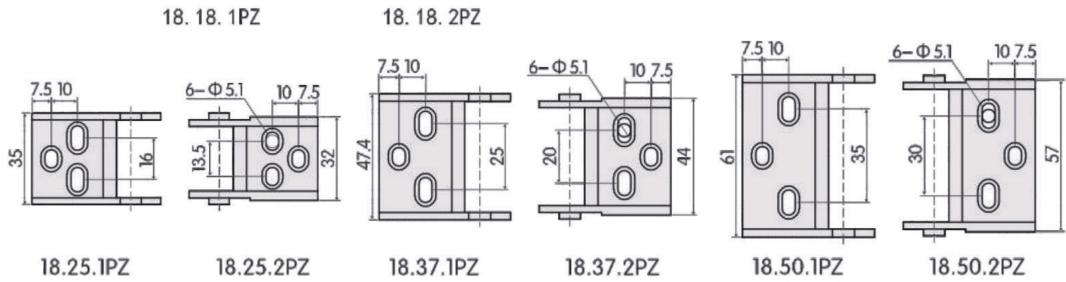

Connector Installation Dimensions 接头安装尺寸图

Article No.	Part No.	Hi	Bi	H	Ba	Bending Radius	Open The Way	Corresponds To The Hole Pitch	Connector Ordering Model
货号	型号	内高	内宽	外高	外宽	弯曲半径 (R)	打开方式	对应接头孔距 (mm)	接头订购型号
A0119.004.0001	18	18	18	23.5	28	28,38,48,60*,75,100*	BF.N	B1=10,B2=12	18.18.1PZ/2PZ
A0119.004.0002	18	18	25	23.5	35		BF.N	A=10,B1=16,B2=13.5	18.25.1PZ/2PZ
A0119.004.0003	18	18	37	23.5	47		BF.N	A=10,B1=25,B2=20	18.37.1PZ/2PZ
A0119.004.0004	18	18	50	23.5	60		BF.N	A=10,B1=35,B2=30	18.50.1PZ/2PZ

*Note: The opening method BF is semi-closed type, N is the inside open type, Bf.N is the semi-closed inside open type.

*Connector type: 18...B.12PZ = Complete U-shaped bevel connector, 18...B.1PZ = One end with hole; 18...B.2PZ = One end with pin.

*注: 打开方式BF为半封闭型, N为内侧打开型, BF.N为半封闭内侧打开型。

*接头型号: 18...B.12PZ=U型斜角接头全套; 18...B.1PZ=一端带孔; 18...B.2PZ=一端带销。

CE RoHS

EASCO® Nylon Cable Chains H20 Series-Both sides of the bridge open EASCO® 尼龙拖链H20系列-桥式两侧可打开

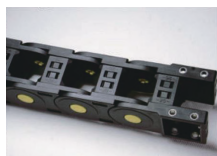
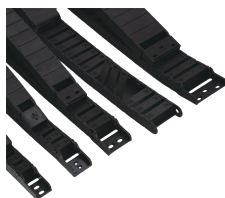

- Basic technical data:
- Pitch=46mm, Number of sections per meter=22.
 - Chain length= $S/2+K$, S =travel distance, $K=\pi \cdot R$ + "safe amount"+1 pitch.
- 主要技术参数:
- 节距=46mm, 每米节数=22。
 - 链长= $S/2+K$, S =行程距离, $K=\pi \cdot R$ +“安全量”+1节距。

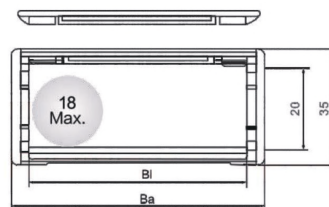
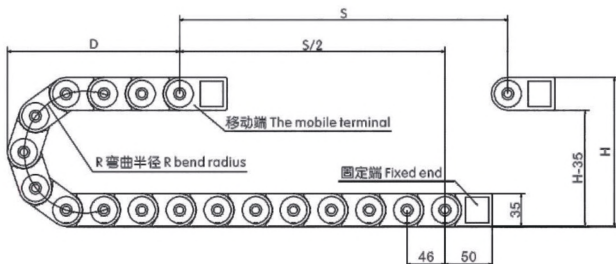

Delineation 示意图

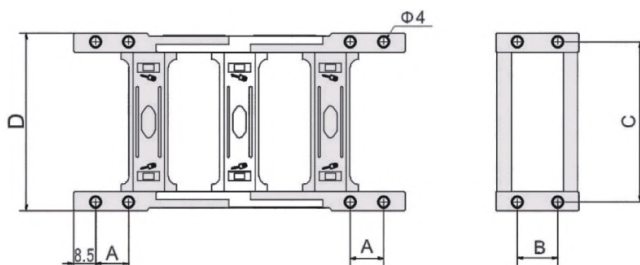

Connector Installation Dimensions 接头安装尺寸图

R	55	75	100	125	150
H	145	185	235	285	335
D	100	115	135	150	185
K	328	392	470	550	630

Article No.	Part No.	Hi	Bi	H	Ba	A	B	C	D	Hole Distance	Hole Margin
货号	型号	内高	内宽	外高	外宽					孔径 (mm)	孔边距 (mm)
A0119.005.0001	H20	20	25	35	45	15	15	37	46	4	8.5
A0119.005.0002	H20	20	38	35	58	15	15	50	59	4	8.5
A0119.005.0003	H20	20	50	35	70	15	15	62	71	4	8.5
A0119.005.0004	H20	20	60	35	80	15	15	72	81	4	8.5
A0119.005.0005	H20	20	75	35	95	15	15	87	96	4	8.5

- A1. Wiring Ducts
- A2. Cable Ties
- A3. Din Rails
- A4. Cable Markers
- A5. Cable Clamps
- A6. Wrapping Bands
- A7. Nylon Cable Gland
- A8. Metal Cable Gland
- A9. Plastic Flexible Conduit
- A10. Metal Flexible Conduit
- A11. Terminal
- A12. Copper Tube Terminals
- A13. Heat Shrinkable Tubings
- A14. Bus Bar Insulators
- A15. Tool
- A16. Cable Clip
- A17. Insulating Nut
- A18. Nylon Cable Carrier

CE RoHS

EASCO® Nylon Cable Chains Series H20-Closed to open on both sides EASCO® 尼龙拖链H20系列-封闭两侧可打开

Basic technical data:

- Pitch=46mm, Number of sections per meter=22.
 - Chain length=S/2+K, S=travel distance, K= $\pi \cdot R$ + "safe amount" + 1 pitch.
- 主要技术参数:
- 节距=46mm, 每米节数=22。
 - 链长=S/2+K, S=行程距离, K= $\pi \cdot R$ + “安全量” + 1节距。

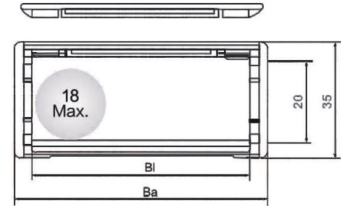
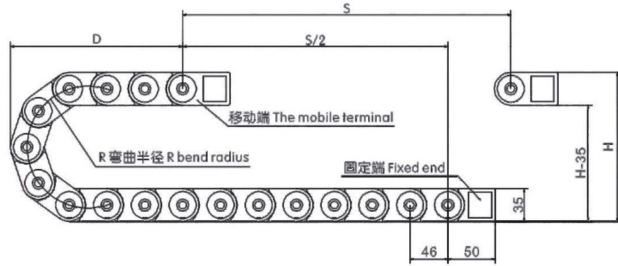

Delineation 示意图

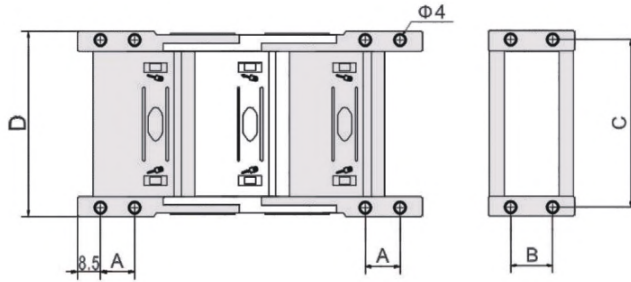

Connector Installation Dimensions 接头安装尺寸图

R	55	75	100	125	150
H	145	185	235	285	335
D	100	115	135	150	185
K	328	392	470	550	630

Article No.	Part No.	Hi	Bi	H	Ba	A	B	C	D	Hole Distance	Hole Margin
										孔径 (mm)	孔边距 (mm)
A0119.005.0006	H20	20	38	35	58	15	15	50	59	4	8.5
A0119.005.0007	H20	20	50	35	70	15	15	62	71	4	8.5
A0119.005.0008	H20	20	60	35	80	15	15	72	81	4	8.5
A0119.005.0009	H20	20	75	35	95	15	15	87	96	4	8.5

CE RoHS

EASCO® Nylon Cable Chains S25 Series Silent bridge be opened on both sides EASCO® 尼龙拖链S25系列-静音桥式两侧可打开



Basic technical data:

- Pitch=22mm, Number of sections per meter=46 .
 - Chain length= $S/2+K$, S =travel distance, $K=\pi \cdot R$ +"safe amount".
- 主要技术参数:
- 节距=22mm, 每米节数=46。
 - 链长= $S/2+K$, S =行程距离, $K=\pi \cdot R$ +"安全量"。

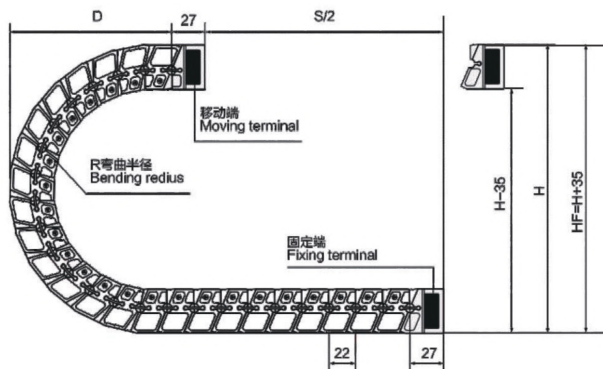
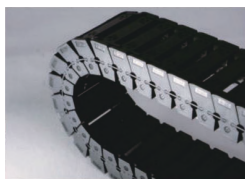
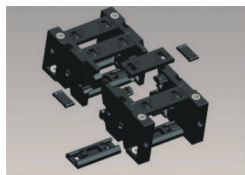

R	55	75	100
H	145	185	235
D	125	150	175
K	276	346	414

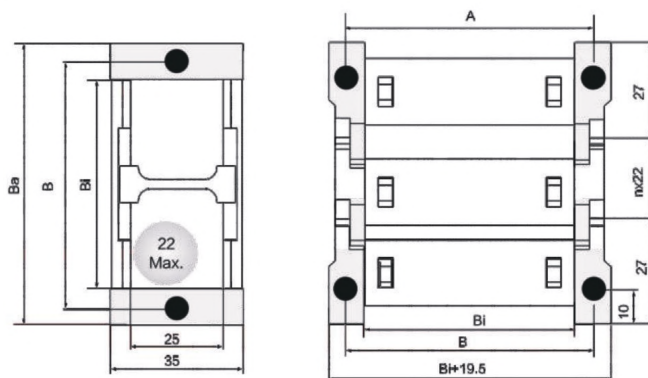

Connector Installation Dimensions 接头安装尺寸图

Article No.	Part No.	Hi	Bi	H	Ba	Bending Radius	Open The Way	Corresponds To The Hole Pitch	Connector Ordering Model
货号	型号	内高	内宽	外高	外宽	弯曲半径 (R)	打开方式	对应接头孔距 (mm)	接头订购型号
A0119.006.0001	S25	25	25	35	42	55,75,100	M	B=35	S25Q.25.12PZ
A0119.006.0002	S25	25	38	35	55	55,75,100	M	B=48	S25Q.38.12PZ
A0119.006.0003	S25	25	57	35	74	55,75,100	M	B=67	S25Q.57.12PZ
A0119.006.0004	S25	25	77	35	94	55,75,100	M	B=87	S25Q.77.12PZ
A0119.006.0005	S25	25	103	35	120	55,75,100	M	B=113	S25Q.103.12PZ

- A1. Wiring Ducts
- A2. Cable Ties
- A3. Din Rails
- A4. Cable Markers
- A5. Cable Clamps
- A6. Wrapping Bands
- A7. Nylon Cable Gland
- A8. Metal Cable Gland
- A9. Plastic Flexible Conduit
- A10. Metal Flexible Conduit
- A11. Terminal
- A12. Copper Tube Terminals
- A13. Heat Shrinkable Tubings
- A14. Bus Bar Insulators
- A15. Tool
- A16. Cable Clip
- A17. Insulating Nut
- A18. Nylon Cable Chains

CE RoHS

EASCO® Nylon Cable Chains J25 Series-Both sides of the bridge open EASCO® 尼龙拖链J25系列-桥式两侧可打开

Basic technical data:

- Pitch=46mm, Number of sections per meter=22.
- Chain length=S/2+K, S=travel distance, K=π.R+"safe amount"+1 pitch.

主要技术参数:

- 节距=46mm, 每米节数=22。
- 链长=S/2+K, S=行程距离, K=π.R+"安全量"+1节距。

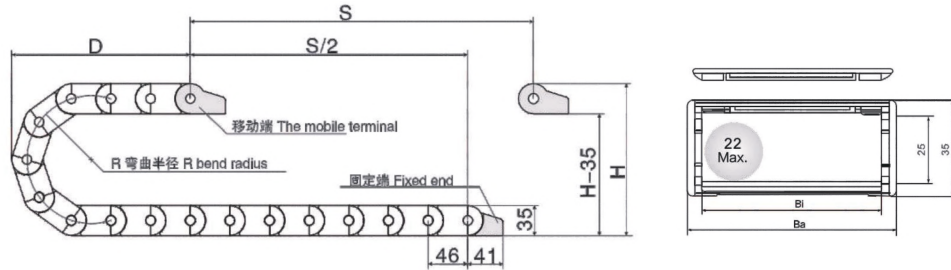

Delineation 示意图

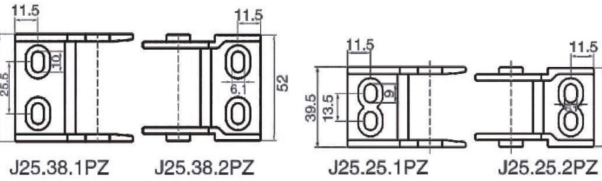

R	55	75	100	125	150	200
H	145	185	235	285	335	335
D	105	110	140	155	190	250
K	344	407	485	564	642	750

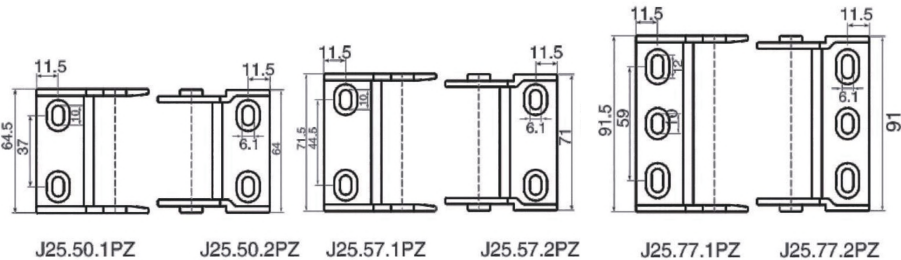

Connector Installation Dimensions 接头安装尺寸图

Article No.	Part No.	Hi	Bi	H	Bending Radius	Open The Way	Corresponds To The Hole Pitch	Connector Ordering Model
货号	型号	内高	内宽	外高	弯曲半径 (R)	打开方式	对应接头孔距 (mm)	接头订购型号
A0119.006.0001	J25	25	25	35	55,75,100, 125,150,200	S	B=13.5	J25.25.Q.12PZ
A0119.006.0002	J25	25	38	35		S	B=25.5	J25.38.Q.12PZ
A0119.006.0003	J25	25	50	35		S	B=37	J25.50.Q.12PZ
A0119.006.0004	J25	25	57	35		S	B=44.5	J25.57.Q.12PZ
A0119.006.0005	J25	25	77	35		S	B=59	J25.77.Q.12PZ

CE RoHS

EASCO® Nylon Cable Chains Series J25- Closed to open on both sides EASCO® 尼龙拖链J25系列-封闭两侧可打开

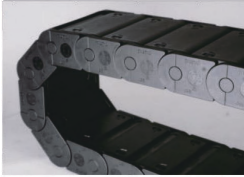

Basic technical data:

- Pitch=46mm, Number of sections per meter=22.
 - Chain length=S/2+K, S=travel distance, K=π.R+"safe amount"+1 pitch.
- 主要技术参数:
- 节距=46mm, 每米节数=22。
 - 链长=S/2+K, S=行程距离, K=π.R+"安全量"+1节距。

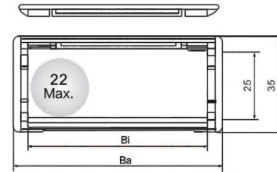
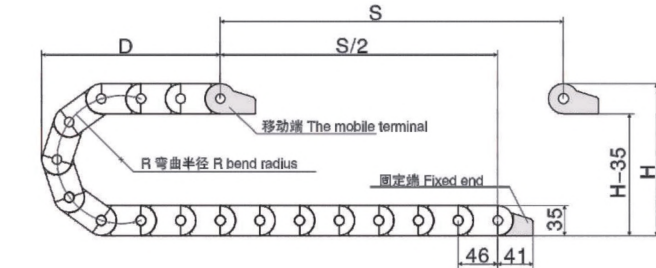

Delineation 示意图

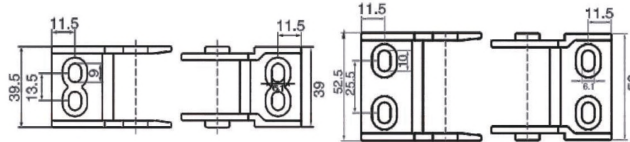

J25.25.1PZ J25.25.2PZ J25.38.1PZ J25.38.2PZ

R	55	75	100	125	150	200
H	145	185	235	285	335	335
D	105	110	140	155	190	250
K	344	407	485	564	642	750

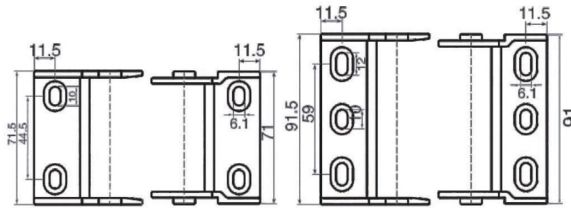

J25.57.1PZ J25.57.2PZ J25.77.1PZ J25.77.2PZ

Connector Installation Dimensions 接头安装尺寸图

Article No.	Part No.	Hi	Bi	H	Bending Radius	Open The Way	Corresponds To The Hole Pitch	Connector Ordering Model
货号	型号	内高	内宽	外高	弯曲半径 (R)	打开方式	对应接头孔距 (mm)	接头订购型号
A0119.007.0006	J25	25	25	35	55,75,100, 125,150,200	S	B=13.5	J25.25.F.12PZ
A0119.007.0007	J25	25	38	35		S	B=25.5	J25.38.F.12PZ
A0119.007.0008	J25	25	57	35		S	B=44.5	J25.57.F.12PZ
A0119.007.0009	J25	25	77	35		S	B=59	J25.77.F.12PZ

A1. Wiring Ducts

A2. Cable Ties

A3. Din Rails

A4. Cable Markers

A5. Cable Clamps

A6. Wrapping Bands

A7. Nylon Cable Gland

A8. Metal Cable Gland

A9. Plastic Flexible Conduit

A10. Metal Flexible Conduit

A11. Terminal

A12. Copper Tube Terminals

A13. Heat Shrinkable Tubings

A14. Bus Bar Insulators

A15. Tool

A16. Cable Clip

A17. Insulating Nut

A18. Nylon Cable Carrier

CE RoHS

EASCO® Nylon Cable Chains H25 Series-Both sides of the bridge open EASCO® 尼龙拖链H25系列-桥式两侧可打开

Basic technical data:

- Pitch=46mm, Number of sections per meter=22.
- Chain length=S/2+K, S=travel distance, K=π.R+"safe amount"+1 pitch.

主要技术参数:

- 节距=46mm, 每米节数=22。
- 链长=S/2+K, S=行程距离, K=π.R+“安全量”+1节距。

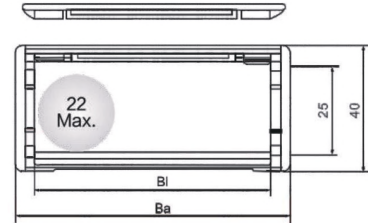
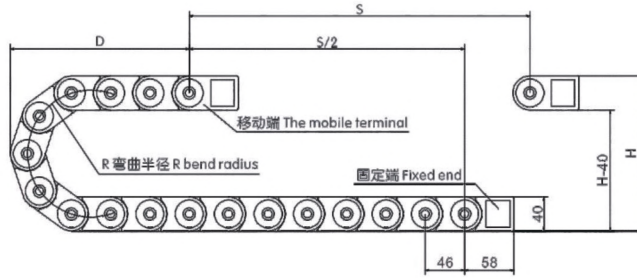
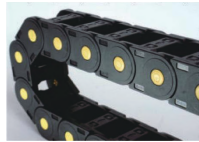

Delineation 示意图

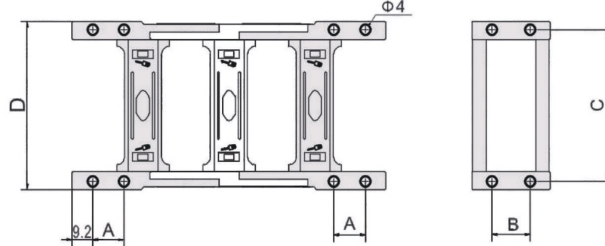

Connector Installation Dimensions 接头安装尺寸图

R	55	75	100	125	150
H	150	190	240	290	340
D	105	110	140	155	190
K	344	407	485	564	642

Article No.	Part No.	Hi	Bi	H	Ba	A	B	C	D	Hole Distance	Hole Margin
货号	型号	内高	内宽	外高	外宽					孔径 (mm)	孔边距 (mm)
A0119.008.0001	H25	25	25	40	45	16	16	37	46	4	9.2
A0119.008.0002	H25	25	38	40	58	16	16	50	59	4	9.2
A0119.008.0003	H25	25	50	40	70	16	16	62	71	4	9.2
A0119.008.0004	H25	25	60	40	80	16	16	72	81	4	9.2
A0119.008.0005	H25	25	75	40	95	16	16	87	96	4	9.2

CE RoHS

EASCO® Nylon Cable Chains Series H25-Closed to open on both sides EASCO® 尼龙拖链H25系列-封闭两侧可打开



Basic technical data:

- Pitch=46mm, Number of sections per meter=22.
 - Chain length=S/2+K, S=travel distance, K=π.R+"safe amount"+1 pitch.
- 主要技术参数:
- 节距=46mm, 每米节数=22。
 - 链长=S/2+K, S=行程距离, K=π.R+“安全量”+1节距。

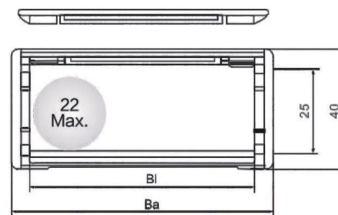
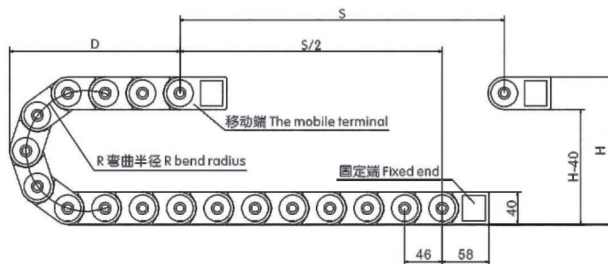

Delineation 示意图

R	55	75	100	125	150
H	150	190	240	290	340
D	105	110	140	155	190
K	344	407	485	564	642

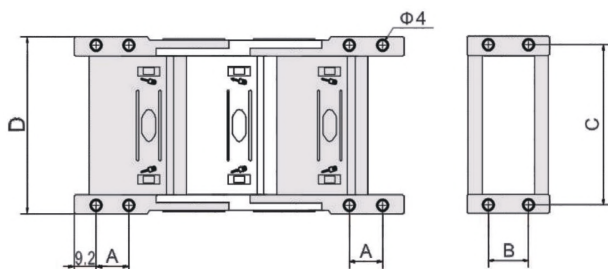

Connector Installation Dimensions 接头安装尺寸图

Article No.	Part No.	Hi	Bi	H	Ba	A	B	C	D	Hole Distance	Hole Margin
										孔径 (mm)	孔边距 (mm)
A0119.008.0006	H25	25	38	40	58	16	16	50	59	4	9.2
A0119.008.0007	H25	25	50	40	70	16	16	62	71	4	9.2
A0119.008.0008	H25	25	60	40	80	16	16	72	81	4	9.2
A0119.008.0009	H25	25	75	40	95	16	16	87	96	4	9.2

- A1. Wiring Ducts
- A2. Cable Ties
- A3. Din Rails
- A4. Cable Markers
- A5. Cable Clamps
- A6. Wrapping Bands
- A7. Nylon Cable Gland
- A8. Metal Cable Gland
- A9. Plastic Flexible Conduit
- A10. Metal Flexible Conduit
- A11. Terminal
- A12. Copper Tube Terminals
- A13. Heat Shrinkable Tubings
- A14. Bus Bar Insulators
- A15. Tool
- A16. Cable Clip
- A17. Insulating Nut
- A18. Nylon Cable Chains

CE RoHS

EASCO® Nylon Cable Chains H30 Series-Both sides of the bridge open EASCO® 尼龙拖链H30系列-桥式两侧可打开



Basic technical data:

- Pitch=46mm, Number of sections per meter=22.
 - Chain length=S/2+K, S=travel distance, K=π.R+"safe amount"+1 pitch.
- 主要技术参数:
- 节距=46mm, 每米节数=22。
 - 链长=S/2+K, S=行程距离, K=π.R+“安全量”+1节距。

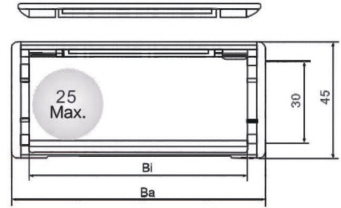
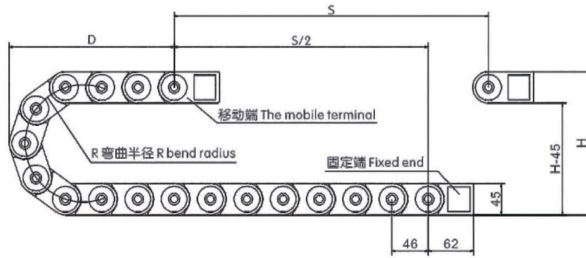

Delineation 示意图

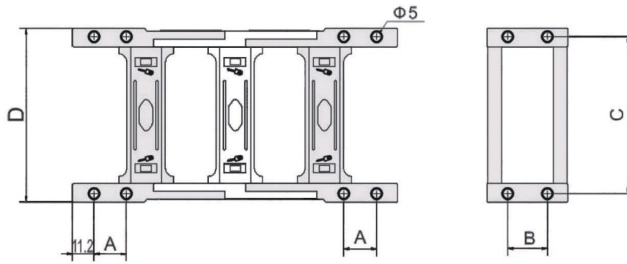

Connector Installation Dimensions 接头安装尺寸图

R	75	100	125	150
H	195	245	295	345
D	115	140	160	185
K	422	501	579	650

Article No.	Part No.	Hi	Bi	H	Ba	A	B	C	D	Hole Distance	Hole Margin
货号	型号	内高	内宽	外高	外宽					孔径 (mm)	孔边距 (mm)
A0119.009.0001	H30	30	25	45	48	18	18	39	49	5	11.2
A0119.009.0002	H30	30	38	45	61	18	18	52	62	5	11.2
A0119.009.0003	H30	30	50	45	73	18	18	64	74	5	11.2
A0119.009.0004	H30	30	60	45	83	18	18	74	84	5	11.2
A0119.009.0005	H30	30	75	45	98	18	18	89	99	5	11.2

CE RoHS

EASCO® Nylon Cable Chains Series H30-Closed to open on both sides EASCO® 尼龙拖链H30系列-封闭两侧可打开



Basic technical data:

- Pitch=46mm, Number of sections per meter=22.
 - Chain length= $S/2+K$, S =travel distance, $K=\pi \cdot R$ + "safe amount"+1 pitch.
- 主要技术参数:
- 节距=46mm, 每米节数=22。
 - 链长= $S/2+K$, S =行程距离, $K=\pi \cdot R$ + "安全量"+1节距。

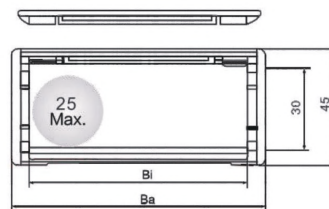
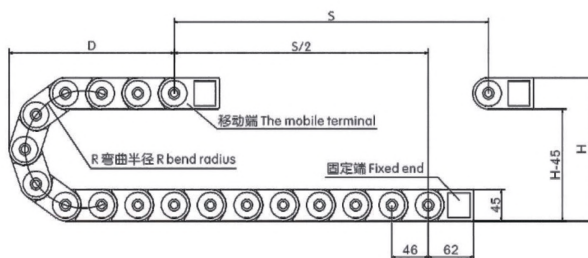
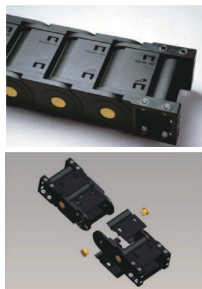

Delineation 示意图

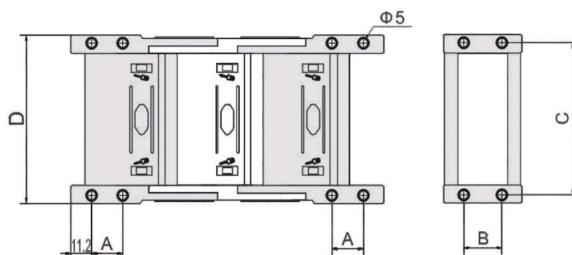

Connector Installation Dimensions 接头安装尺寸图

R	75	100	125	150
H	195	245	295	345
D	115	140	160	185
K	422	501	579	650

Article No.	Part No.	Hi	Bi	H	Ba	A	B	C	D	Hole Distance	Hole Margin
										孔径 (mm)	孔边距 (mm)
货号	型号	内高	内宽	外高	外宽						
A0119.009.0006	H30	30	38	45	61	18	18	52	62	5	11.2
A0119.009.0007	H30	30	50	45	73	18	18	64	74	5	11.2
A0119.009.0008	H30	30	60	45	83	18	18	74	84	5	11.2
A0119.009.0009	H30	30	75	45	98	18	18	89	99	5	11.2

A1. Wiring Ducts

A2. Cable Ties

A3. Din Rails

A4. Cable Markers

A5. Cable Clamps

A6. Wrapping Bands

A7. Nylon Cable Gland

A8. Metal Cable Gland

A9. Plastic Flexible Conduit

A10. Metal Flexible Conduit

A11. Terminal

A12. Copper Tube Terminals

A13. Heat Shrinkable Tubings

A14. Bus Bar Insulators

A15. Tool

A16. Cable Clip

A17. Insulating Nut

A18. Nylon Cable Carrier

CE RoHS

EASCO® Nylon Cable Chains H35 Series-Both sides of the bridge open EASCO® 尼龙拖链H35系列-桥式两侧可打开

Basic technical data:

- Pitch=66mm, Number of sections per meter=15.
- Chain length=S/2+K, S=travel distance, K=π.R+"safe amount"+1 pitch.

主要技术参数:

- 节距=66mm, 每米节数=15。
- 链长=S/2+K, S=行程距离, K=π.R+“安全量”+1节距。

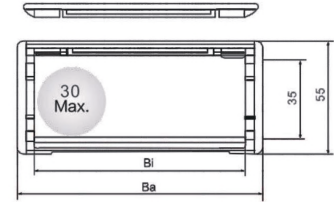
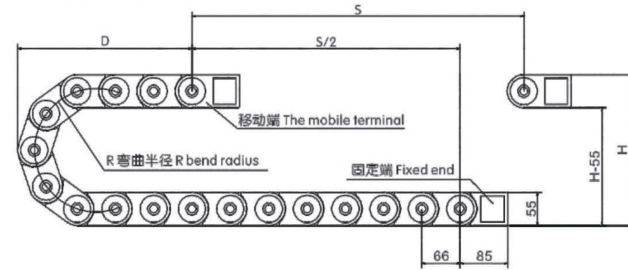
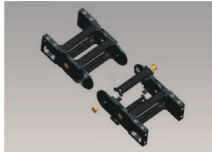

Delineation 示意图

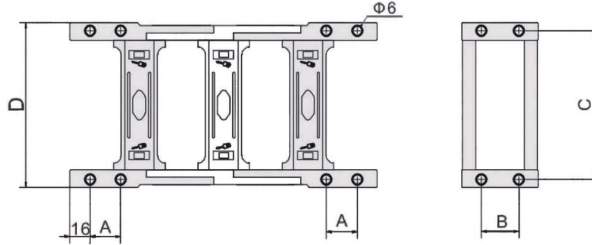

Connector Installation Dimensions 接头安装尺寸图

R	75	100	125	150	200
H	205	255	305	355	455
D	130	155	180	205	255
K	474	552	631	709	866

Article No.	Part No.	Hi	Bi	H	Ba	A	B	C	D	Hole Distance	Hole Margin
										孔径 (mm)	孔边距 (mm)
A0119.010.0001	H35	35	50	55	77	24	24	65	78	6	16
A0119.010.0002	H35	35	75	55	102	24	24	90	103	6	16
A0119.010.0003	H35	35	100	55	127	24	24	116	128	6	16
A0119.010.0004	H35	35	125	55	152	24	24	141	153	6	16
A0119.010.0005	H35	35	150	55	177	24	24	166	178	6	16
A0119.010.0006	H35	35	175	55	202	24	24	191	203	6	16
A0119.010.0007	H35	35	200	55	227	24	24	216	228	6	16

CE RoHS

EASCO® Nylon Cable Chains Series H35-Closed to open on both sides EASCO® 尼龙拖链H35系列-封闭两侧可打开



Basic technical data:

- Pitch=66mm, Number of sections per meter=15.
 - Chain length=S/2+K, S=travel distance, K=π.R+"safe amount"+1 pitch.
- 主要技术参数:
- 节距=66mm, 每米节数=15。
 - 链长=S/2+K, S=行程距离, K=π.R+“安全量”+1节距。

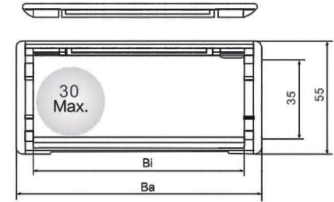
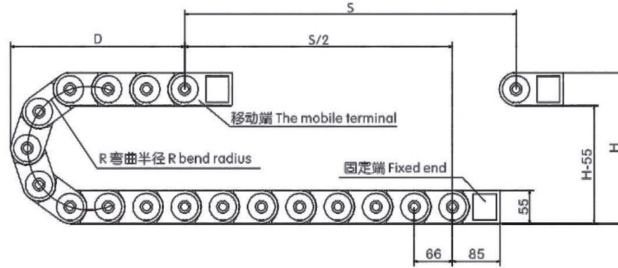
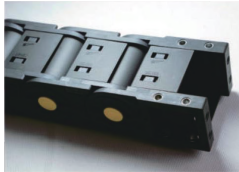

Delineation 示意图

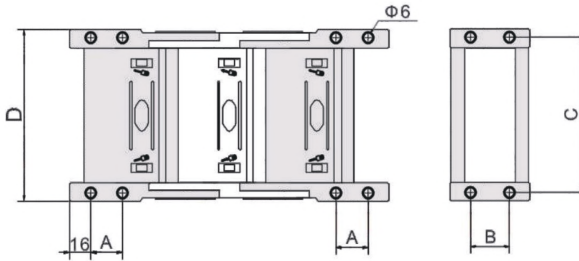

Connector Installation Dimensions 接头安装尺寸图

R	75	100	125	150	200
H	205	255	305	355	455
D	130	155	180	205	255
K	474	552	631	709	866

Article No.	Part No.	Hi	Bi	H	Ba	A	B	C	D	Hole Distance	Hole Margin
货号	型号	内高	内宽	外高	外宽					孔径 (mm)	孔边距 (mm)
A0119.010.0008	H35	35	50	55	77	24	24	65	78	6	16
A0119.010.0009	H35	35	75	55	102	24	24	90	103	6	16
A0119.010.0010	H35	35	100	55	127	24	24	116	128	6	16
A0119.010.0011	H35	35	125	55	152	24	24	141	153	6	16
A0119.010.0012	H35	35	150	55	177	24	24	166	178	6	16

CE RoHS

EASCO® Nylon Cable Chains H45 Series-Both sides of the bridge open EASCO® 尼龙拖链H45系列-桥式两侧可打开



Basic technical data:

- Pitch=80mm, Number of sections per meter=13.
 - Chain length=S/2+K, S=travel distance, K=π.R+"safe amount"+1 pitch.
- 主要技术参数:
- 节距=80mm, 每米节数=13。
 - 链长=S/2+K, S=行程距离, K=π.R+“安全量”+1节距。

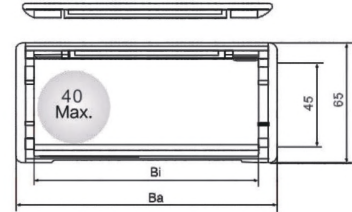
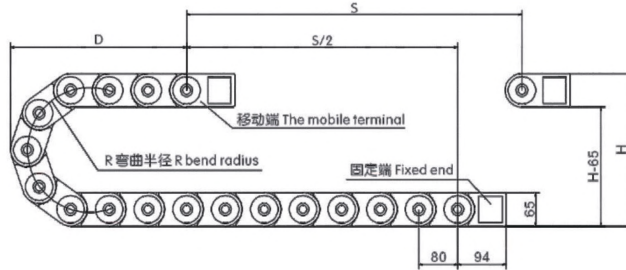

Delineation 示意图

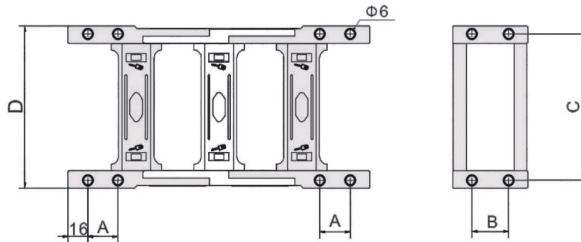

R	75	100	125	150	200	250*
H	215	265	315	365	456	565
D	120	155	190	215	260	310
K	519	598	676	755	912	1069

Connector Installation Dimensions 接头安装尺寸图

Article No.	Part No.	Hi	Bi	H	Ba	A	B	C	D	Hole Distance	Hole Margin
货号	型号	内高	内宽	外高	外宽					孔径 (mm)	孔边距 (mm)
A0119.011.0001	H45	45	50	65	80	24	26	68	84	6	16
A0119.011.0002	H45	45	75	65	105	24	26	93	109	6	16
A0119.011.0003	H45	45	100	65	130	24	26	119	134	6	16
A0119.011.0004	H45	45	125	65	155	24	26	144	159	6	16
A0119.011.0005	H45	45	150	65	180	24	26	169	184	6	16
A0119.011.0006	H45	45	175	65	205	24	26	194	209	6	16
A0119.011.0007	H45	45	200	65	230	24	26	219	234	6	16

CE RoHS

EASCO® Nylon Cable Chains Series H45-Closed to open on both sides EASCO® 尼龙拖链H45系列-封闭两侧可打开



Basic technical data:

- Pitch=80mm, Number of sections per meter=13.
 - Chain length=S/2+K, S=travel distance, K=π.R+"safe amount"+1 pitch.
- 主要技术参数:
- 节距=80mm, 每米节数=13。
 - 链长=S/2+K, S=行程距离, K=π.R+"安全量"+1节距。

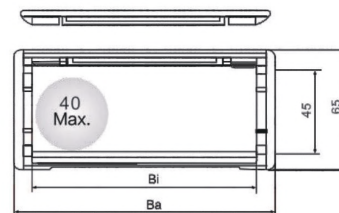
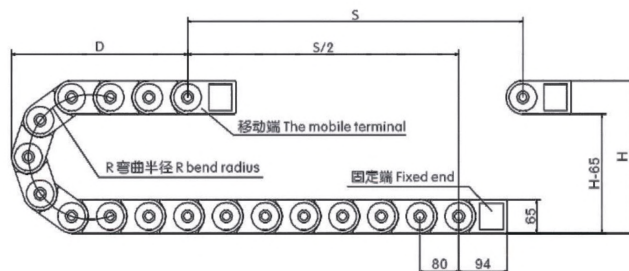

Delineation 示意图

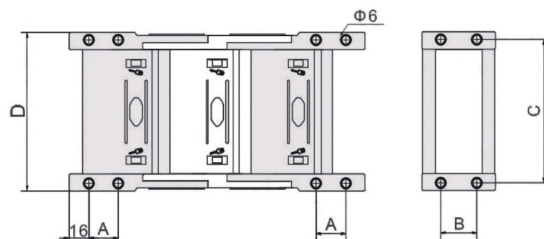

R	75	100	125	150	200	250*
H	215	265	315	365	456	565
D	120	155	190	215	260	310
K	519	598	676	755	912	1069

Connector Installation Dimensions 接头安装尺寸图

Article No.	Part No.	Hi	Bi	H	Ba	A	B	C	D	Hole Distance	Hole Margin
货号	型号	内高	内宽	外高	外宽					孔径 (mm)	孔边距 (mm)
A0119.011.0008	H45	45	50	65	80	24	26	68	84	6	16
A0119.011.0009	H45	45	75	65	105	24	26	93	109	6	16
A0119.011.0010	H45	45	100	65	130	24	26	119	134	6	16
A0119.011.0011	H45	45	125	65	155	24	26	144	159	6	16
A0119.011.0012	H45	45	150	65	180	24	26	169	184	6	16
A0119.011.0013	H45	45	175	65	205	24	26	194	209	6	16
A0119.011.0014	H45	45	200	65	230	24	26	219	234	6	16

A1. Wiring Ducts

A2. Cable Ties

A3. Din Rails

A4. Cable Markers

A5. Cable Clamps

A6. Wrapping Bands

A7. Nylon Cable Gland

A8. Metal Cable Gland

A9. Plastic Flexible Conduit

A10. Metal Flexible Conduit

A11. Terminal

A12. Copper Tube Terminals

A13. Heat Shrinkable Tubings

A14. Bus Bar Insulators

A15. Tool

A16. Cable Clip

A17. Insulating Nut

A18. Nylon Cable Carrier

CE RoHS

EASCO® Nylon Cable Chains H55 Series-Both sides of the bridge open EASCO® 尼龙拖链H55系列-桥式两侧可打开

Basic technical data:

- Pitch=80mm, Number of sections per meter=13.
 - Chain length=S/2+K, S=travel distance, K= $\pi \cdot R$ + "safe amount"+1 pitch.
- 主要技术参数:
- 节距=80mm, 每米节数=13。
 - 链长=S/2+K, S=行程距离, K= $\pi \cdot R$ +“安全量”+1节距。

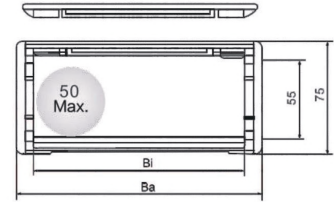
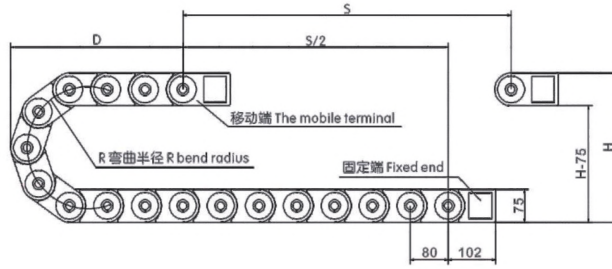
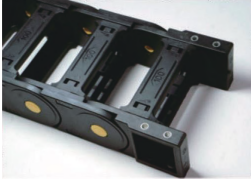

Delineation 示意图

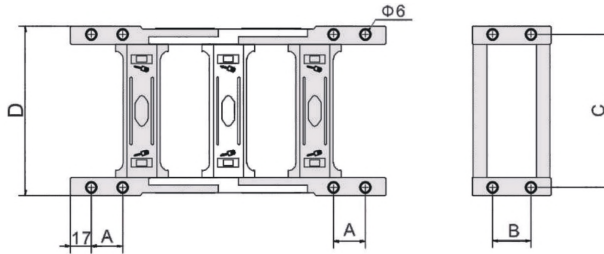

Connector Installation Dimensions 接头安装尺寸图

R	75	100	125	150	200	300*
H	225	275	325	375	475	675
D	160	180	195	235	300	400
K	551	629	708	786	943	1257

Article No.	Part No.	Hi	Bi	H	Ba	A	B	C	D	Hole Distance	Hole Margin
										孔径 (mm)	孔边距 (mm)
A0119.012.0001	H55	55	50	75	83	30	30	69.5	85	6	17
A0119.012.0002	H55	55	75	75	108	30	30	94.5	110	6	17
A0119.012.0003	H55	55	100	75	134	30	30	119.5	136	6	17
A0119.012.0004	H55	55	125	75	159	30	30	145.5	161	6	17
A0119.012.0005	H55	55	150	75	184	30	30	170.5	186	6	17
A0119.012.0006	H55	55	175	75	209	30	30	195.5	211	6	17
A0119.012.0007	H55	55	200	75	234	30	30	210.5	236	6	17

CE RoHS

EASCO® Nylon Cable Chains Series H55-Closed to open on both sides EASCO® 尼龙拖链H55系列-封闭两侧可打开



Basic technical data:

- Pitch=80mm, Number of sections per meter=13.
 - Chain length=S/2+K, S=travel distance, K=π.R+"safe amount"+1 pitch.
- 主要技术参数:
- 节距=80mm, 每米节数=13。
 - 链长=S/2+K, S=行程距离, K=π.R+“安全量”+1节距。

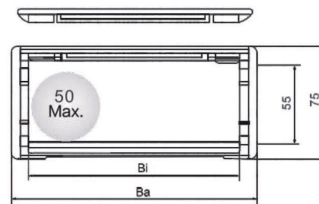
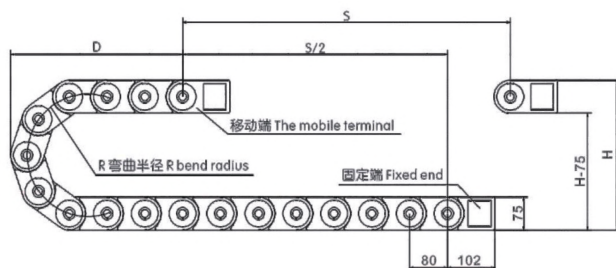

Delineation 示意图

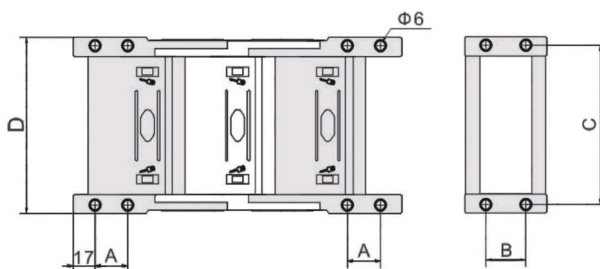

Connector Installation Dimensions 接头安装尺寸图

R	75	100	125	150	200	300*
H	225	275	325	375	475	675
D	160	180	195	235	300	400
K	551	629	708	786	943	1257

Article No.	Part No.	Hi	Bi	H	Ba	A	B	C	D	Hole Distance	
										孔径 (mm)	孔边距 (mm)
货号	型号	内高	内宽	外高	外宽						
A0119.012.0008	H55	55	50	75	83	30	30	69.5	85	6	17
A0119.012.0009	H55	55	75	75	108	30	30	94.5	110	6	17
A0119.012.0010	H55	55	100	75	133	30	30	120.5	135	6	17
A0119.012.0011	H55	55	125	75	159	30	30	145.5	161	6	17
A0119.012.0012	H55	55	150	75	184	30	30	170.5	186	6	17
A0119.012.0013	H55	55	175	75	209	30	30	195.5	211	6	17
A0119.012.0014	H55	55	200	75	234	30	30	220.5	236	6	17

- A1. Wiring Ducts
- A2. Cable Ties
- A3. Din Rails
- A4. Cable Markers
- A5. Cable Clamps
- A6. Wrapping Bands
- A7. Nylon Cable Gland
- A8. Metal Cable Gland
- A9. Plastic Flexible Conduit
- A10. Metal Flexible Conduit
- A11. Terminal
- A12. Copper Tube Terminals
- A13. Heat Shrinkable Tubings
- A14. Bus Bar Insulators
- A15. Tool
- A16. Cable Clip
- A17. Insulating Nut
- A18. Nylon Cable Chains

CE RoHS EASCO® Nylon Cable Chains H65 Series-Both sides of the bridge open EASCO® 尼龙拖链H65系列-桥式两侧可打开



Basic technical data:

- Pitch=80mm, Number of sections per meter=13.
 - Chain length=S/2+K, S=travel distance, K=π.R+"safe amount"+1 pitch.
- 主要技术参数:
- 节距=80mm, 每米节数=13。
 - 链长=S/2+K, S=行程距离, K=π.R+“安全量”+1节距。

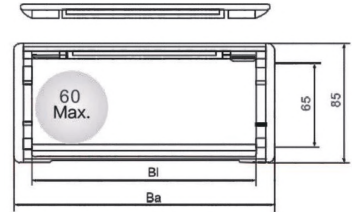
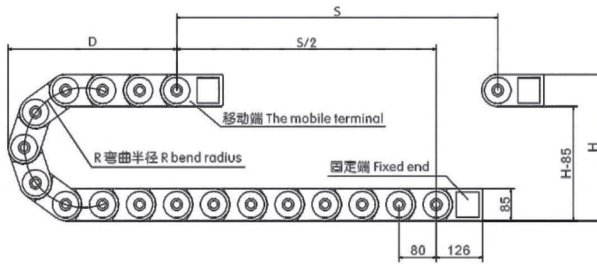
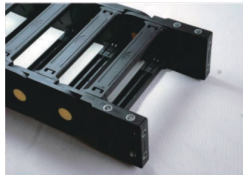

Delineation 示意图

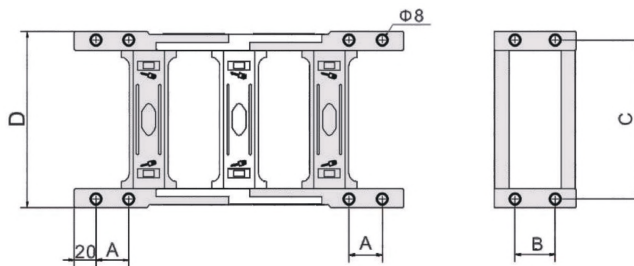

Connector Installation Dimensions 接头安装尺寸图

R	125	150	200	350	300
H	335	385	485	585	685
D	200	220	270	325	365
K	739	818	975	1132	1288

Article No.	Part No.	Hi	Bi	H	Ba	A	B	C	D	Hole Distance	Hole Margin
货号	型号	内高	内宽	外高	外宽					孔径 (mm)	孔边距 (mm)
A0119.013.0001	H65	65	50	85	86	35	45	72	92	8	20
A0119.013.0002	H65	65	75	85	111	35	45	97	117	8	20
A0119.013.0003	H65	65	100	85	137	35	45	123	143	8	20
A0119.013.0004	H65	65	125	85	162	35	45	148	168	8	20
A0119.013.0005	H65	65	150	85	187	35	45	173	193	8	20
A0119.013.0006	H65	65	175	85	212	35	45	198	218	8	20
A0119.013.0007	H65	65	200	85	237	35	45	223	243	8	20

CE RoHS

EASCO® Nylon Cable Chains Series H65-Closed to open on both sides EASCO® 尼龙拖链H65系列-封闭两侧可打开



Basic technical data:

- Pitch=80mm, Number of sections per meter=13.
 - Chain length= $S/2+K$, S =travel distance, $K=\pi \cdot R$ + "safe amount"+1 pitch.
- 主要技术参数:
- 节距=80mm, 每米节数=13。
 - 链长= $S/2+K$, S =行程距离, $K=\pi \cdot R$ +“安全量”+1节距。

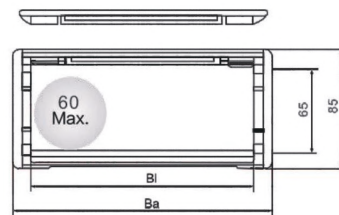
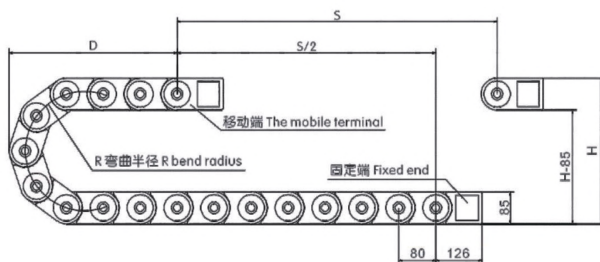

Delineation 示意图

R	125	150	200	350	300
H	335	385	485	585	685
D	200	220	270	325	365
K	739	818	975	1132	1288

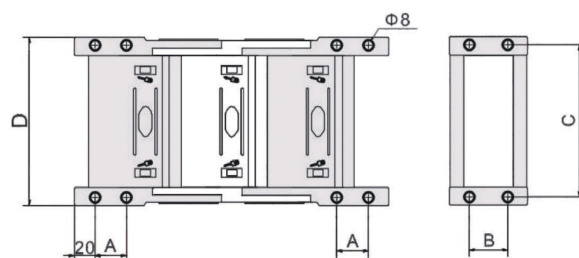

Connector Installation Dimensions 接头安装尺寸图

Article No.	Part No.	Hi	Bi	H	Ba	A	B	C	D	Hole Distance	Hole Margin
货号	型号	内高	内宽	外高	外宽					孔径 (mm)	孔边距 (mm)
A0119.013.0008	H65	65	50	85	86	35	45	72	92	8	20
A0119.013.0009	H65	65	75	85	111	35	45	97	117	8	20
A0119.013.0010	H65	65	100	85	137	35	45	123	143	8	20
A0119.013.0011	H65	65	125	85	162	35	45	148	168	8	20
A0119.013.0012	H65	65	150	85	187	35	45	173	193	8	20
A0119.013.0013	H65	65	175	85	212	35	45	198	218	8	20
A0119.013.0014	H65	65	200	85	237	35	45	223	243	8	20

A1. Wiring Ducts

A2. Cable Ties

A3. Din Rails

A4. Cable Markers

A5. Cable Clamps

A6. Wrapping Bands

A7. Nylon Cable Gland

A8. Metal Cable Gland

A9. Plastic Flexible Conduit

A10. Metal Flexible Conduit

A11. Terminal

A12. Copper Tube Terminals

A13. Heat Shrinkable Tubings

A14. Bus Bar Insulators

A15. Tool

A16. Cable Clip

A17. Insulating Nut

A18. Nylon Cable Carrier